

## LANDSCAPE AND PLACEMAKING

The network of green spaces and corridors will make a significant contribution towards the establishment of a 'Green Ring' of interlinked landscaped spaces and routes all around South Woodham Ferrers.

These spaces and corridors are multifunctional and offer a diverse and exciting benefit to the town as a whole for residents of all ages. They vary in character along their length or edges but are unified by a common function or feature. Each space and corridor is described over the following pages in terms of scale, function, features and benefits, with explanatory diagrams and images.

The ten areas are:

- L01 Burnham Road Frontage;
- L02 B1418 Frontage;
- L03 Northern Boundary and Mill Hill;
- L04 Central Green Spine;
- L05 Hedgerow Corridor;
- L06 Stream Corridor;
- L07 Formal Recreation;
- L08 Bushy Hill Boundary;
- L09 Eastern Boundary;
- L10 Pylon Corridor.

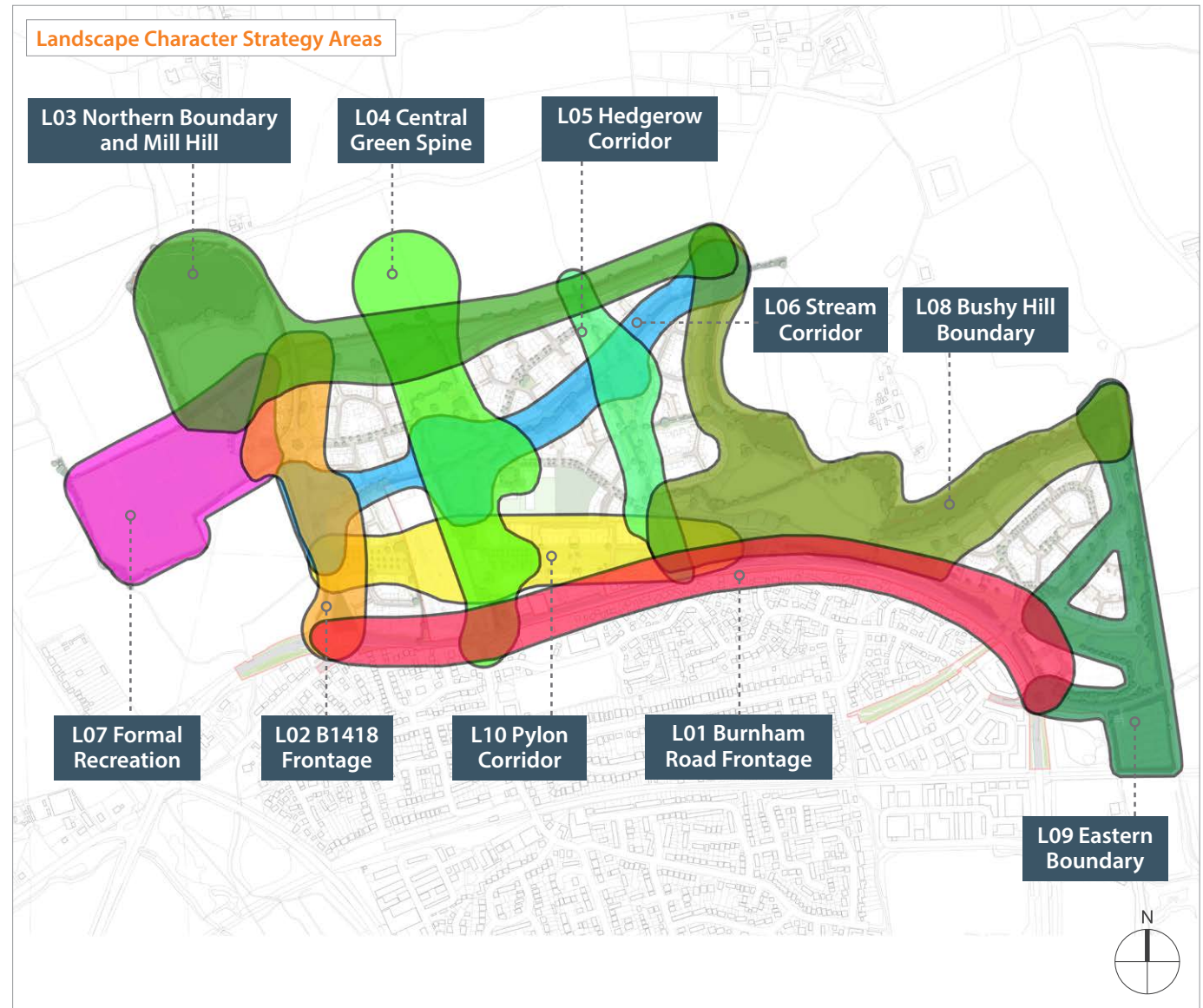

# DESIGN

## PUBLIC REALM AREAS - L01 BURNHAM ROAD FRONTAGE

The Burnham Road Frontage is a linear open space that runs the length of the southern edge of the site providing a link between the town and the new development. It varies along its length as it intersects other landscape areas but is principally a transport corridor.

L02 the B1418 Frontage corridor, L04 Central Green Spine, L05 Hedgerow Corridor, L08 Bushy Hill Boundary, L09

Eastern Boundary and L10 the pylon corridor intersect with this space.

The existing roadside hedgerows and trees would be retained and form part of the landscape structure unless removed to form the access points.

The space would be well connected along its length, both northwards into the site and to the town to the south.

Enhanced boundary vegetation is proposed to complement the existing planting along the roadside.

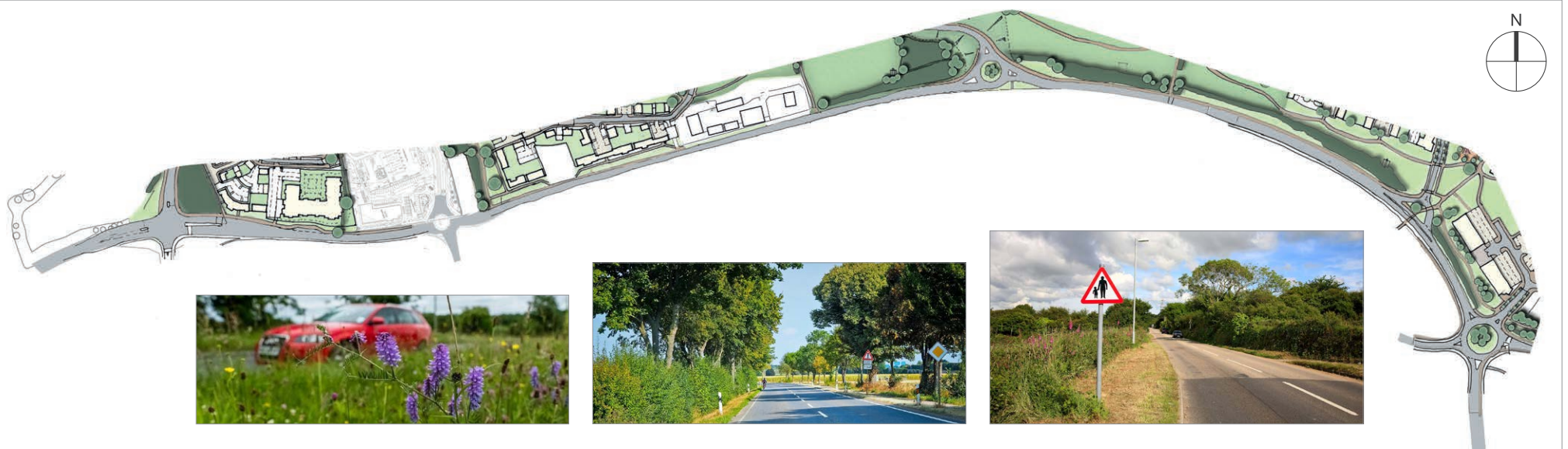

### EXISTING ELEMENTS

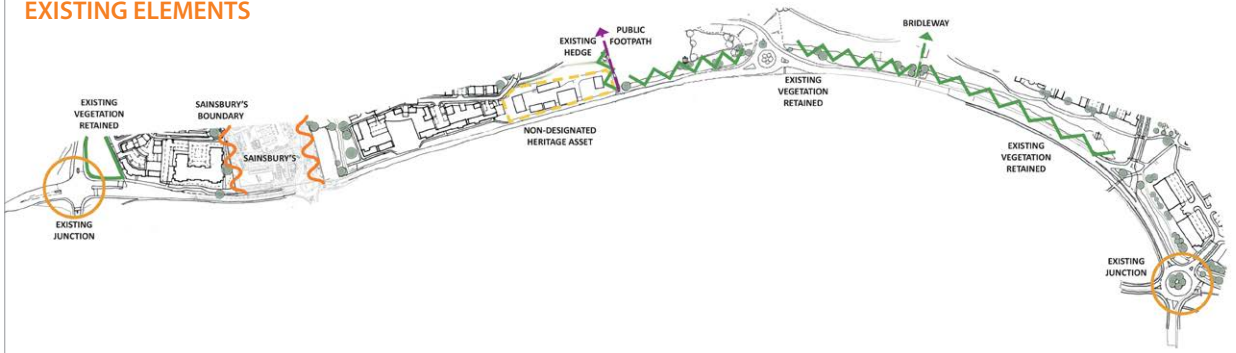

### PROPOSED ROUTES

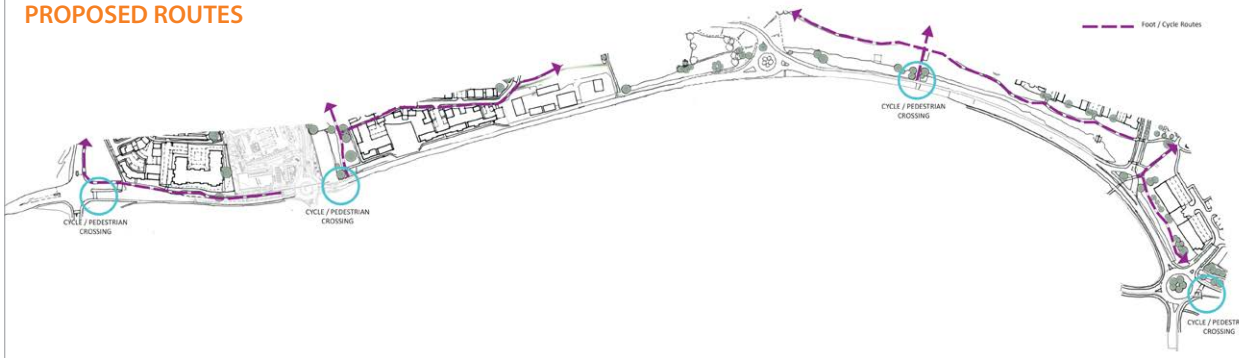

### PROPOSED ILLUSTRATIVE FEATURES

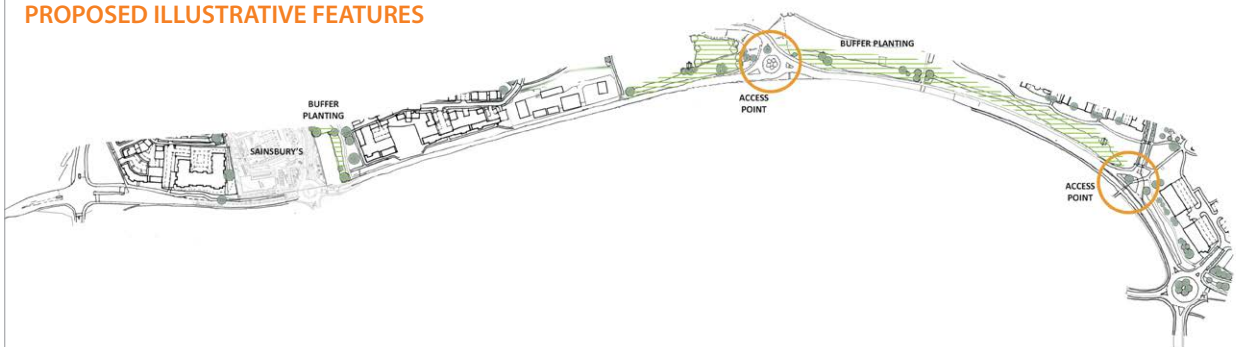

## L01 BURNHAM ROAD FRONTAGE

- Scale** 1,600 x 50m
- Function**
  - Linear corridor between Burnham Road and the existing town
  - Provides access points and linkages
  - Bridleway link to Bushy Hill
- Landscape features** Existing trees and hedgerows retained
- Proposed drainage basins**
- Benefits**
  - Wildflower grassland on northern edge at Bushy Hill
  - New copses and tree planting



# DESIGN

## PUBLIC REALM AREAS - L02 B1418 FRONTAGE

This linear movement corridor runs north – south, primarily connecting Burnham Road to the development site and the wider countryside to the north.

The new alignment of the B1418, and the surrounding landscape proposals retain the existing vegetation, including hedges around the new access.

The proposed junction forms the access point into the site with dry basins featuring as the part of the entrance open spaces to the east and west.

The southern part of this corridor features a retained block of woodland to the east and the transition between Countryside Properties land and the Bellway land to the west.

The northern section of the B1418 Frontage intersects with L03 Northern Boundary providing foot and cycle links to Mill Hill and the open countryside to the north.

The B1418 Frontage also intersects with, and provides access to, L07 Formal Recreation.

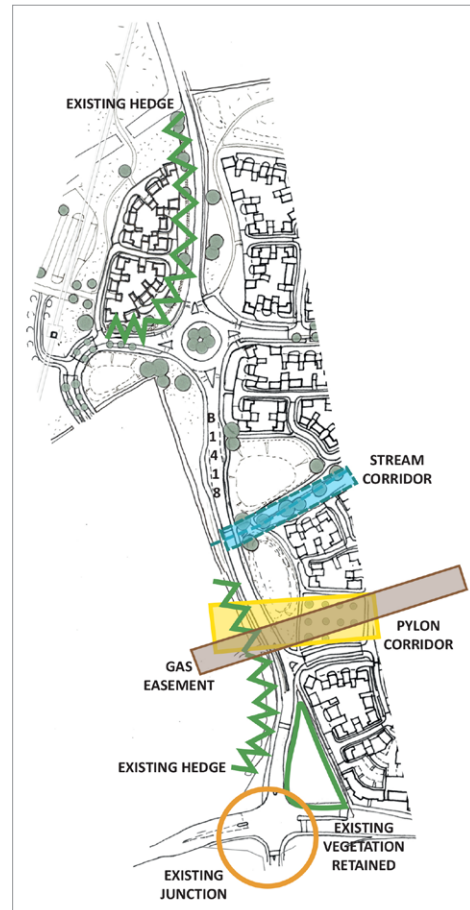

EXISTING FEATURES



PROPOSED ROUTES

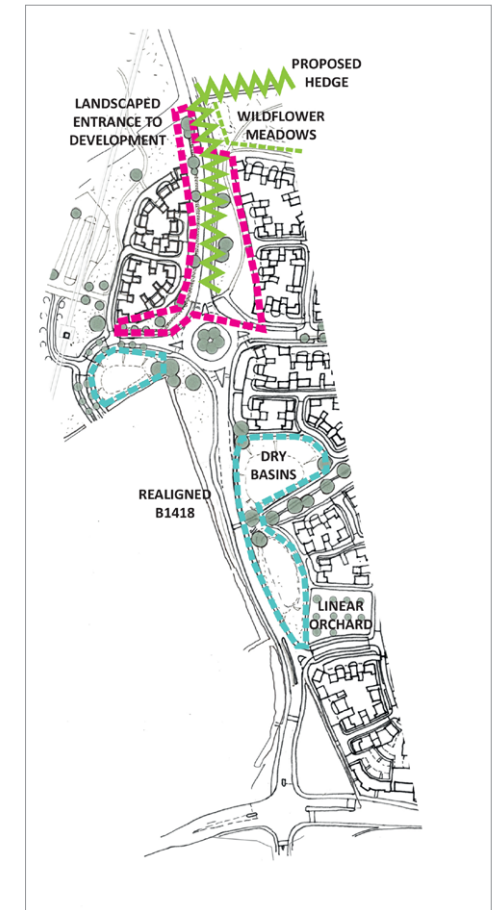

PROPOSED ILLUSTRATIVE FEATURES





**L02 B1418 FRONTAGE**

- Scale** 635m x 190m
- Function** Linear transport corridor from Burnham Road northwards through the site t  
Provides access points and linkages
- Landscape features** Existing trees and hedgerows retained  
Proposed drainage basins
- Benefits** Tree planting  
Connection with the countryside beyond  
Green spaces at the entrance points into the development



# DESIGN

## PUBLIC REALM AREAS - LO3 NORTHERN BOUNDARY AND MILL HILL

Located on the site's northern boundary is an east-west, linear, open space corridor that is naturalistic in character. This space provides a transition from the new development to the open countryside beyond.

The corridor features wildflower meadow and informal planting. Existing vegetation is retained and reinforced, hedgerows with occasional trees

are to be replanted on the northern edge of the site.

Foot and cycle routes throughout the open space link to the higher ground and to Edwin's Hall Road to the north, encouraging both existing and future residents to connect with and enjoy the countryside.

To the west of the corridor new access routes are introduced on the southern slopes of Mill Hill and the existing grassland retained for biodiversity purposes. The northern face of Mill Hill is to be planted with new woodland for carbon sequestration and habitat creation benefits.

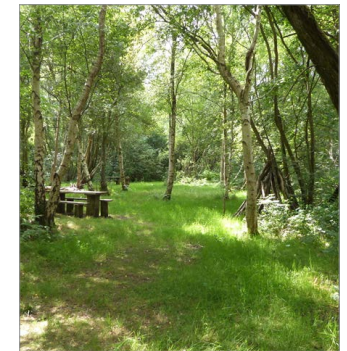

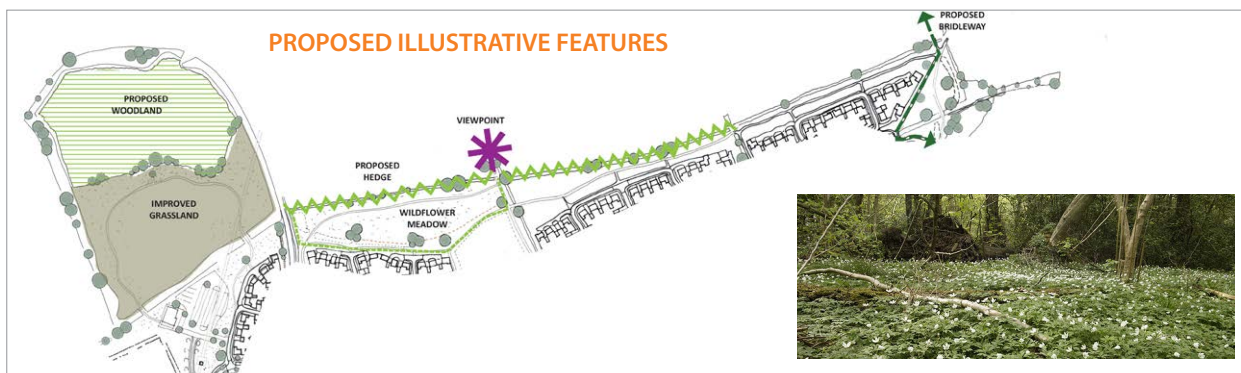
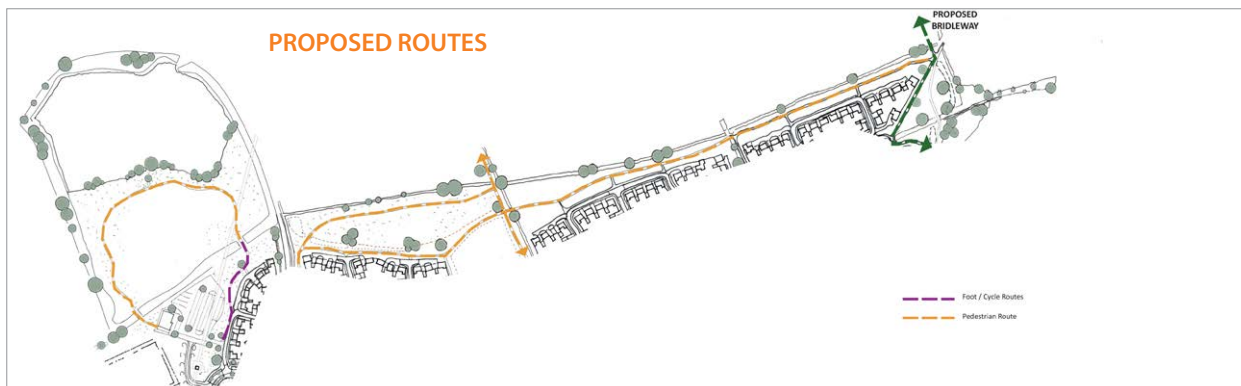
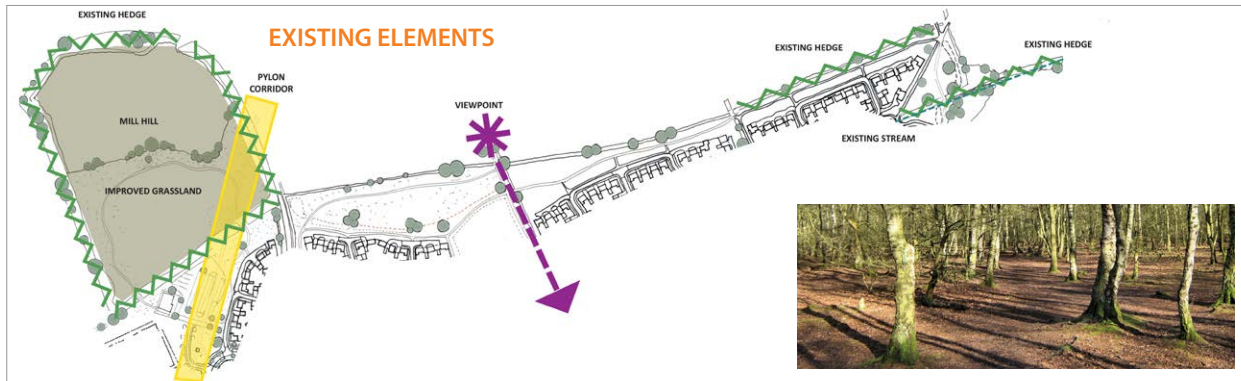

## L03 NORTHERN BOUNDARY AND MILL HILL

- Scale** 345m x 1165m
- Function** Linear corridor on the northern edge of the site providing a transition between the development and open countryside
- Landscape features** Existing trees and hedgerows retained and reinforced  
New woodland and enhanced grassland on Mill Hill
- Benefits** Informal Planting and wildflower meadows  
Connections to the countryside and PRoW network  
Biodiversity enhancement  
New tree planting



## PUBLIC REALM AREAS - L04 CENTRAL GREEN SPINE

The Central Green Spine is a vibrant and varied multi-functional open space that runs through the heart of the site between the Burnham Road / Hullbridge Road junction and the central hilltop to the north of the site. This alignment retains the existing visual connection across the site from Hullbridge Road and Burnham Road, and also provides an extension through the site of the existing movement corridor along Hullbridge Road, linking the heart of the new development with the railway station and the heart of the town.

L01 the Burnham Road corridor, L03 the stream corridor, and L10 the pylon corridor intersect with this space.

Part of the western edge of this space is formed by the Sainsbury's site.

The existing hedgerows and trees would be retained and form part of the landscape structure.

Part of the cycleway network for the site runs through this space, linking

to Burnham Road through the Village Square and Spine Road.

The space would be well connected along its length, both within the site, to the town and to the open countryside to the north.

A planted buffer zone is proposed along the western boundary to complement the screen planting within the Sainsbury's site. This is broken by the pylon corridor. The allotments are located within the pylon corridor in conjunction with a linear orchard of low growing fruit trees.

A NEAP is located adjacent to the Village Square to provide a focus to the corridor.

Opportunities for informal play and local events are provided to the north of the Spine Road.

The wildflower meadow on the northern boundary marks a gentle transition to the open countryside beyond and the permissive route to the high point on Hullbridge Hill and Edwin's Hall Road beyond. The corridor is more informal in nature to the north to reflect this link to the countryside.

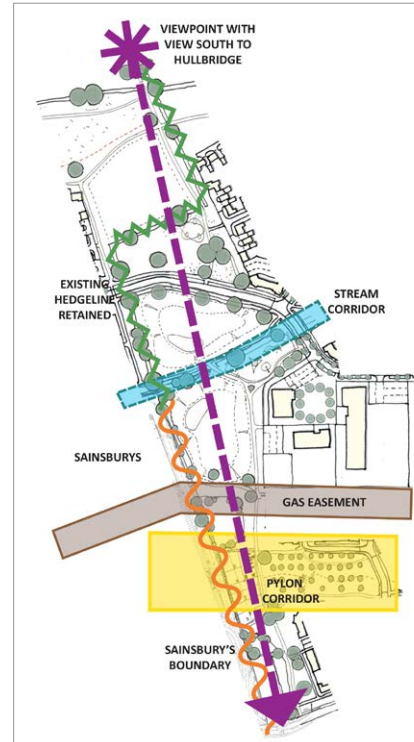

EXISTING FEATURES

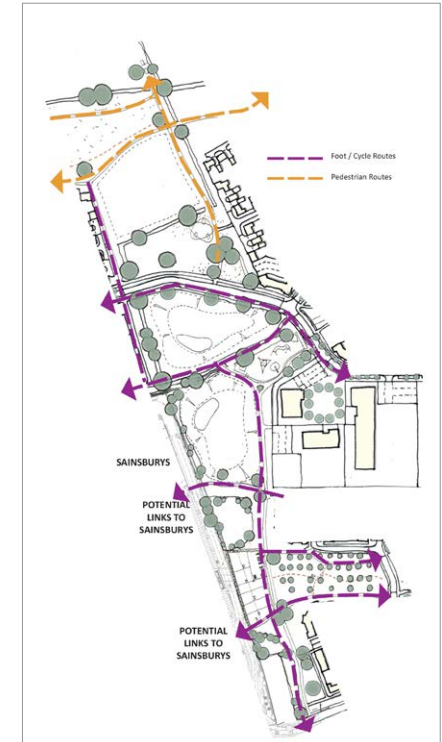

PROPOSED ROUTES





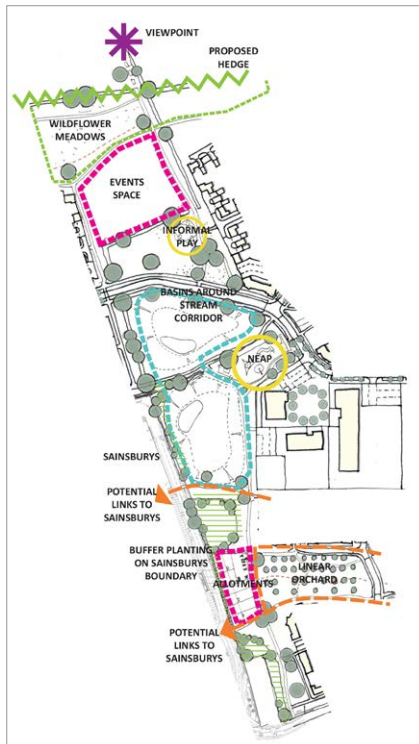

PROPOSED ILLUSTRATIVE FEATURES



## L04 CENTRAL GREEN SPINE

- Scale** 760m x 175m
- Function** Linear corridor from Burnham Road northwards through the site to the high point at "Hullbridge Hill".  
The Sainsburys site forms part of the western edge. The pylon corridor forms part of this space
- Landscape features** Watercourse and streamside vegetation  
Buffer planting  
Existing trees and hedgerows retained  
Proposed drainage basins
- Benefits** NEAP, plus opportunity for play space north of Spine Road,  
Events space  
Linear orchard, Allotments  
Wildflower grassland on northern edge,  
New copses and tree planting

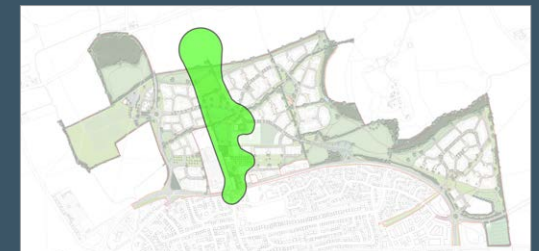

# DESIGN

## PUBLIC REALM AREAS - L05 HEDGEROW CORRIDOR

The Hedgerow Corridor is a north-south green finger that runs through the site. It contains an existing hedgerow, tree line and public footpath. This linear open space is created around these valuable features within the existing landscape structure to preserve and enhance them.

Due to the focus on existing features the proposed landscape throughout the corridor is naturalistic in character, bringing the countryside onto the resident's doorsteps.

The footpaths connect to a wider network leading to walking routes beyond the site to Mill Hill and Edwin's Hall Road.

A strategic play area is set within this sequence of greens.

A dry basin forms part of the open space to the east where the corridor intersects with L06 Stream Corridor.

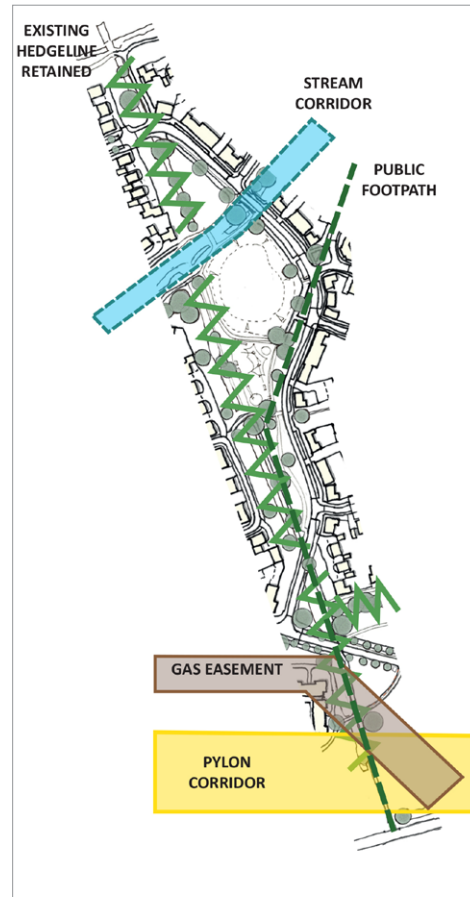

EXISTING FEATURES



PROPOSED ROUTES

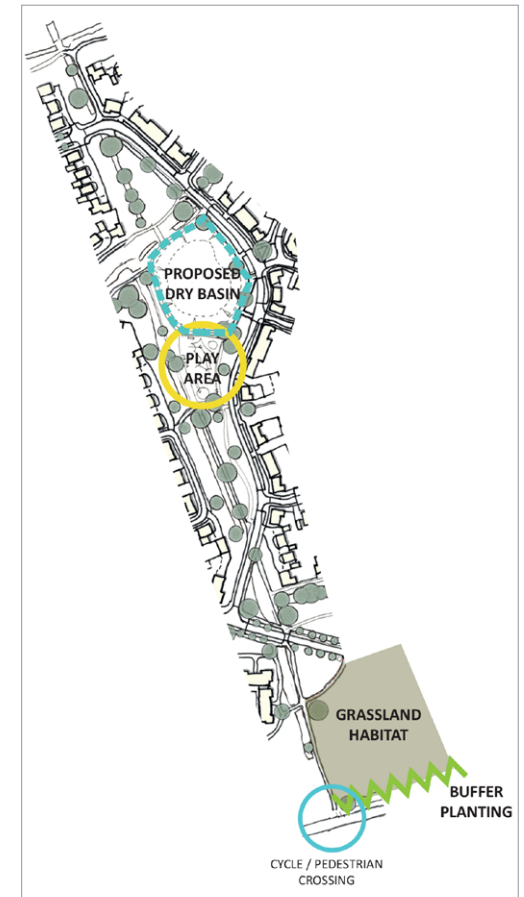

PROPOSED ILLUSTRATIVE FEATURES





## L05 HEDGEROW CORRIDOR

- Scale** 680m x 100m
- Function** Linear corridor with a sequence of green spaces focused along an existing hedgerow
  - Retaining existing PRoW route
- Landscape features** Existing trees and hedgerows retained and reinforced
  - Proposed drainage basins
- Benefits** Play space
  - New tree planting
  - Connections to the wider PRoW network



# DESIGN

## PUBLIC REALM AREAS - L06 STREAM CORRIDOR

Running east-west through the site, an existing watercourse connects the central areas of the development and provides the opportunity to bring landscape, biodiversity, and water management to the heart of the site.

The L06 open space corridor is focussed on the existing watercourse and surrounding landscape structure of hedgerows and tree lines, creating a naturalistic feel to the landscape.

The combination of existing and proposed landscape elements within the corridor offers opportunity for habitat creation, and biodiversity enhancements.

The drainage strategy aims to mimic the natural drainage regime therefore placing dry basins along the watercourse both to the north and south. These basins form part of the open spaces.

The green spaces along the stream feature key walking and cycling routes that help connect the strategic open spaces across the development while also leading to walking routes beyond the site to Mill Hill and Edwin's Hall Road.

A central play space is set in a sequence of greens around the village centre where the Stream Corridor intersects with The Central Green Spine.

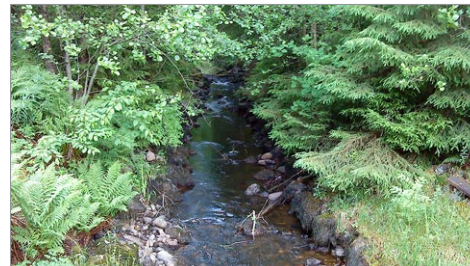
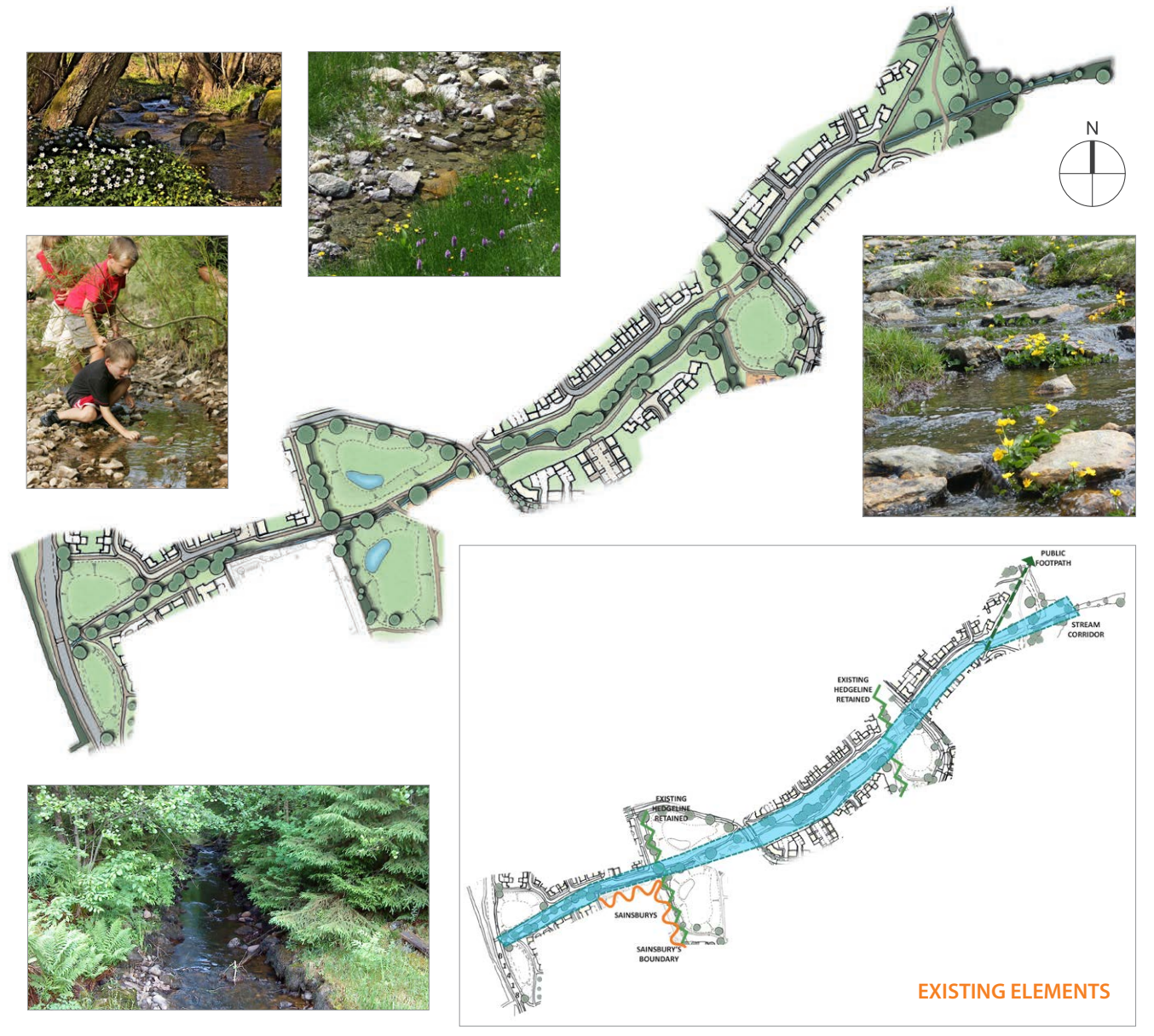
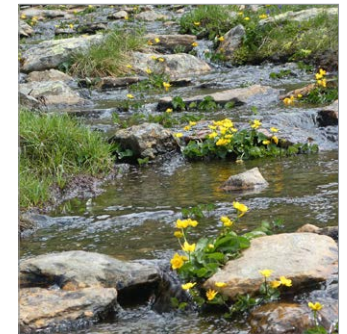

EXISTING ELEMENTS

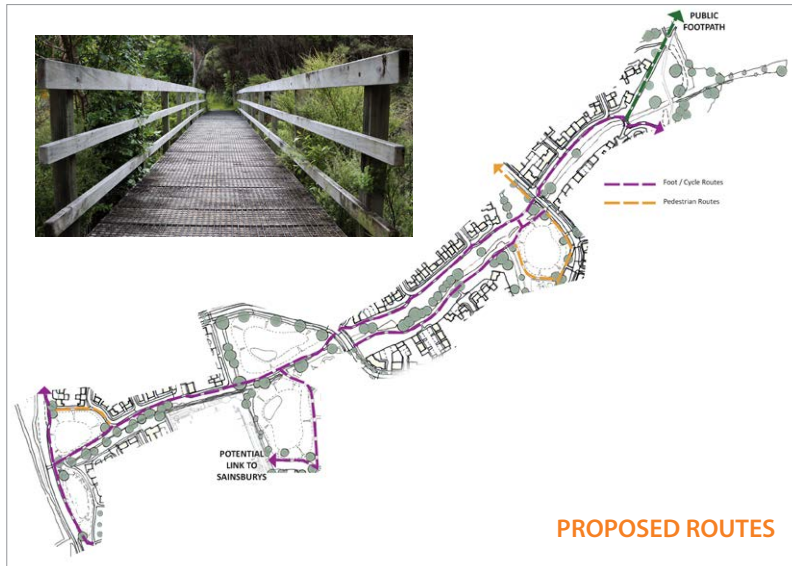

PROPOSED ROUTES

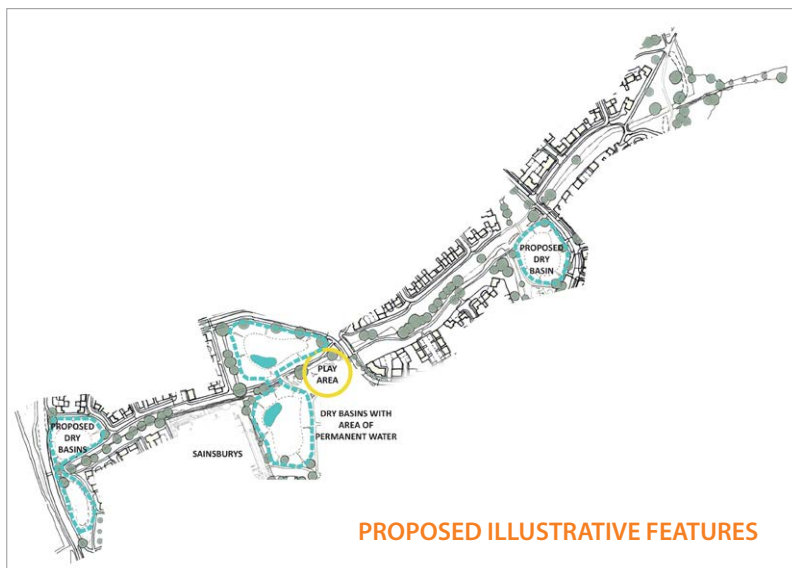
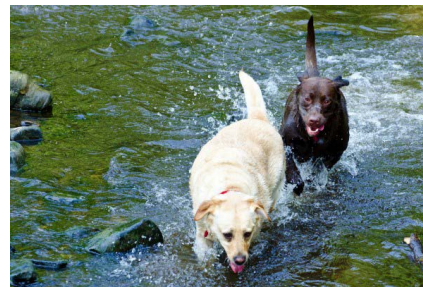

PROPOSED ILLUSTRATIVE FEATURES

## L06 STREAM CORRIDOR

- Scale** 80m x 1100m
- Function** Key walking, cycling, landscape and biodiversity corridor through the heart of the site  
Focuses on the existing watercourse
- Landscape features** Watercourse and streamside vegetation  
Existing trees and hedgerows retained  
Proposed drainage basins
- Benefits** NEAP  
Biodiversity enhancements



# DESIGN

## PUBLIC REALM AREAS - L07 FORMAL RECREATION

This is an area of formal sports provision and associated infrastructure, including parking and changing facilities. The application will secure the use of this area for formal recreation with detailed design to be subject to future reserved matters submissions.

Its location on the north western part of the site provides a green edge to the development, creating a more naturalistic

feel to the western and northern edges of this space where existing watercourses are found.

A dry basin forms part of the open space in the south-east corner where B1418 junction intersects with, and leads to, the Formal Recreation area. The entrance space also provides a connection to the future development land to the South.

Additionally, this open space leads to the walking route on Mill Hill, Public Rights of Way to the west and north, and pedestrian and cycle routes along the northern boundary and Edwin's Hall Road.



### EXISTING FEATURES

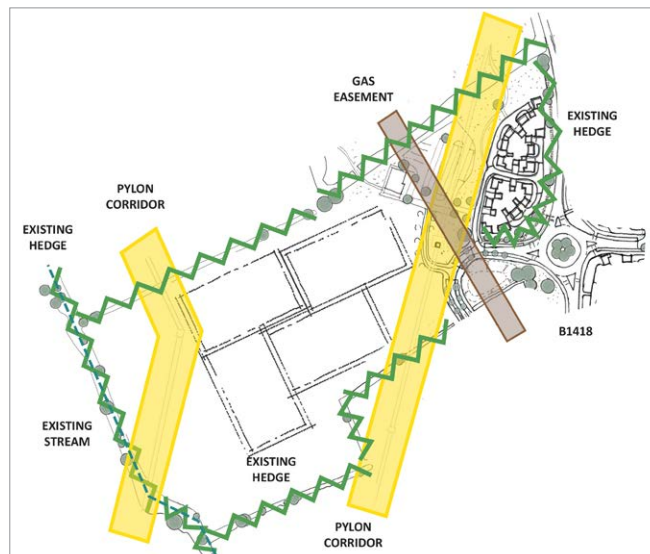

### PROPOSED ROUTES



### PROPOSED ILLUSTRATIVE FEATURES

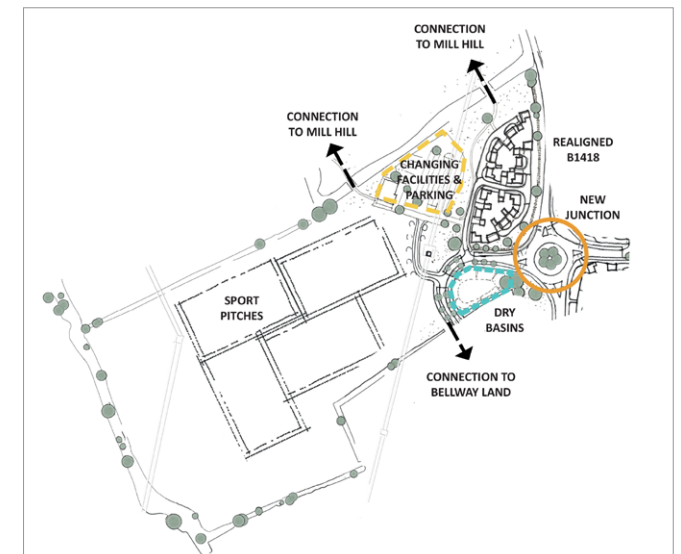



## L07 FORMAL RECREATION

- Scale** 250m x 415m
- Function** Area of formal sport provision and associated facilities
- Landscape features** Watercourse and streamside vegetation  
Existing trees and hedgerows retained  
Proposed drainage basins
- Benefits** Formal sport pitches  
Connections to the wider PRoW network  
Provides a green edge to the north western part of the site



# DESIGN

## PUBLIC REALM AREAS - L08 BUSHY HILL BOUNDARY

Bushy Hill is a vantage point offering views of South Woodham Ferrers to the south and the open countryside to the north. A Local Wildlife Site (LWS) takes up part of Bushy Hill and extends within the site's boundary.

The landscape strategy for the eastern boundary of the site, which wraps around the bottom of Bushy Hill, is focussed around the LWS and, as such, is viewed as a key biodiversity enhancement area within the development.

The enhancements proposed include additional biodiversity ponds together with enhancements to existing grassland areas.

Woodland planting within the site boundary, around the base of Bushy Hill, will be incorporated to extend Edwin's Hall Wood and provide visual mitigation.

These proposed elements will maintain and enhance the naturalistic feel of the landscape along the Bushy Hill Boundary.

This boundary also includes a network of walking and cycling routes that link to the wider walking routes and the PRoW network beyond the site.

A new bridleway route, wrapping around the western edge of the hill, will connect two existing Public Rights of Way. The route will lead north-eastward from the site to Edwin's Hall Road and the wider countryside beyond.

This open space will provide places for quiet contemplation.

One of the access points from Burnham Road into the development is located on south west corner of this open space, providing an open naturalistic entrance space to the development.

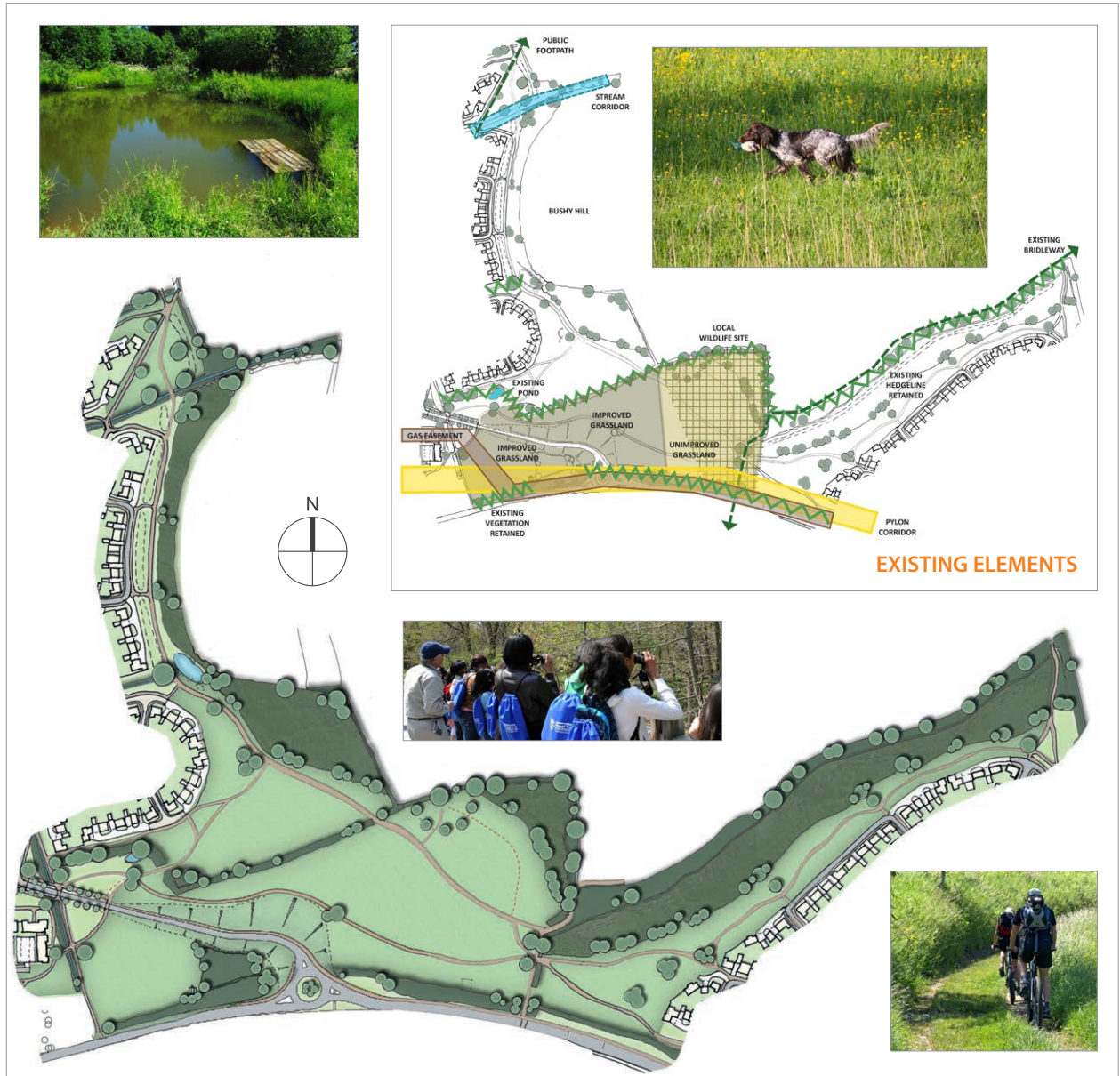



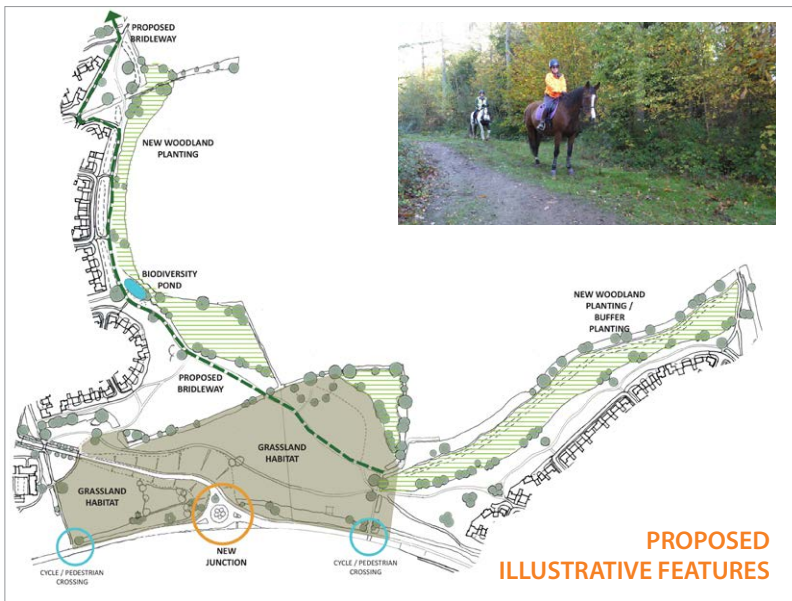

## L08 BUSHY HILL BOUNDARY

- Scale** 705m x 970m
- Function** Key biodiversity enhancement area focussed around the Local Wildlife Site
- Landscape features**
  - Buffer planting
  - Existing trees and hedgerows retained
  - Existing grassland enhances
  - Biodiversity ponds
- Benefits**
  - Biodiversity enhancements
  - New woodland planting
  - Connections to wider PRow network
  - Place for quiet contemplation



# DESIGN

## PUBLIC REALM AREAS - L09 EASTERN BOUNDARY

The open spaces in this area are of a semi-natural character, creating a transition between the development parcels and the surrounding landscape.

A landscape buffer to the eastern edge features new woodland planting to provide added visual mitigation. Dry basins in the south east form part of this landscape buffer.

The existing and proposed landscape structure to the south of this open space provides a landscaped setting to the access points from Burnham Road and Woodham Road.

This sequence of green spaces provide a plethora of pedestrian and cycle routes which connect this area of the site to the rest of the development to the west. They also connect Bushy Hill to Burnham and Woodham Road, and finally, connect the site to the countryside and wider PRow network beyond.

The south east corner, separated from the main site by Woodham Road contains new allotment provision and a link to the Garden of Remembrance and Saltcoats Park to the south.

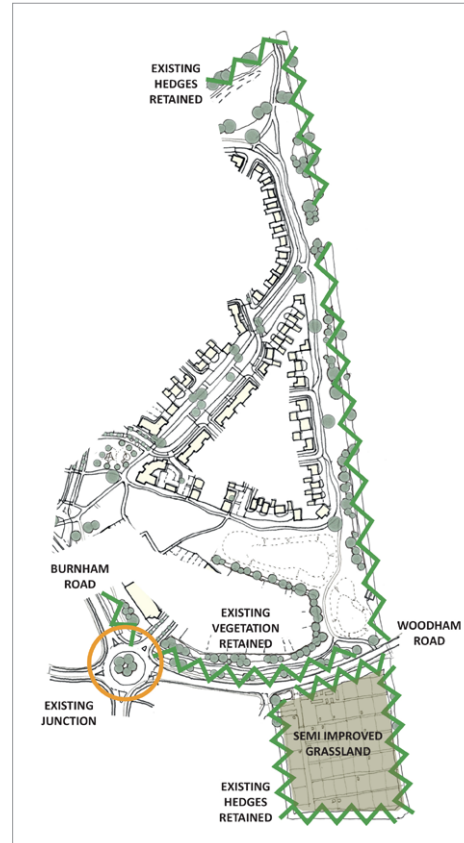

EXISTING FEATURES

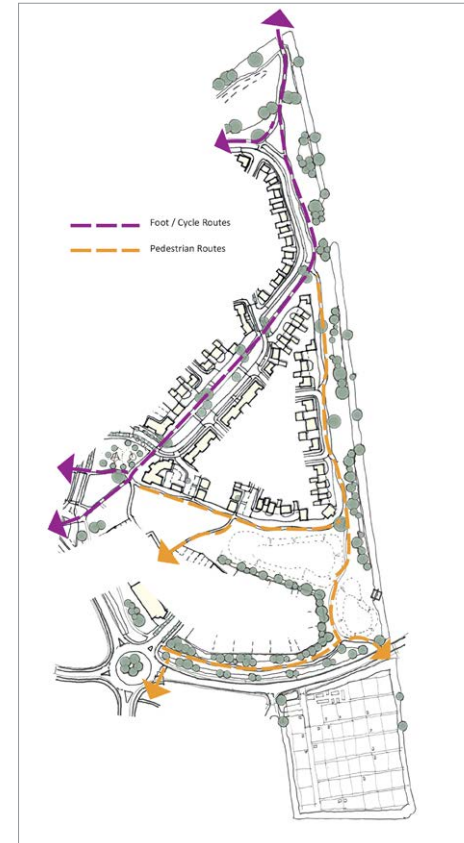

PROPOSED ROUTES

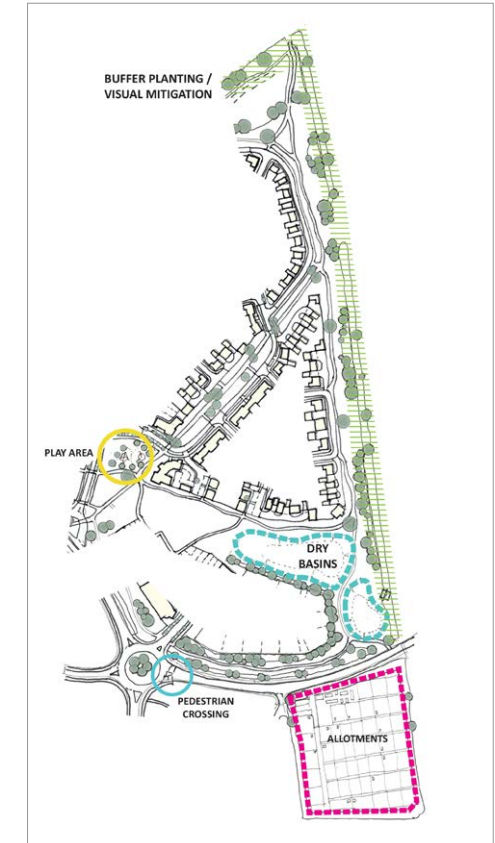

PROPOSED ILLUSTRATIVE FEATURES





## L09 EASTERN BOUNDARY

- Scale** 775m x 305m
- Function** Semi-naturalistic landscape buffer providing a transition between the development and open countryside
- Landscape features**
  - Buffer planting
  - Existing trees and hedgerows retained
  - Proposed drainage basins
- Benefits**
  - Visual mitigation
  - New woodland planting
  - Links to Garden of Remembrance, Saltcoats Park and wider PRow network
  - Allotments
  - Biodiversity enhancements



# DESIGN

## PUBLIC REALM AREAS - L10 PYLON CORRIDOR

The Pylon Corridor open space turns a site constraint into an opportunity to provide an additional green link that runs east-west through the site.

This linear green space contains walking and cycling routes linking the site to the wider PRow network.

New allotment provision is located to the east of the Sainsbury's boundary, in conjunction with a linear orchard of low growing fruit trees.

The corridor also contains areas of enhanced grassland, adding to the biodiversity benefit of the space.



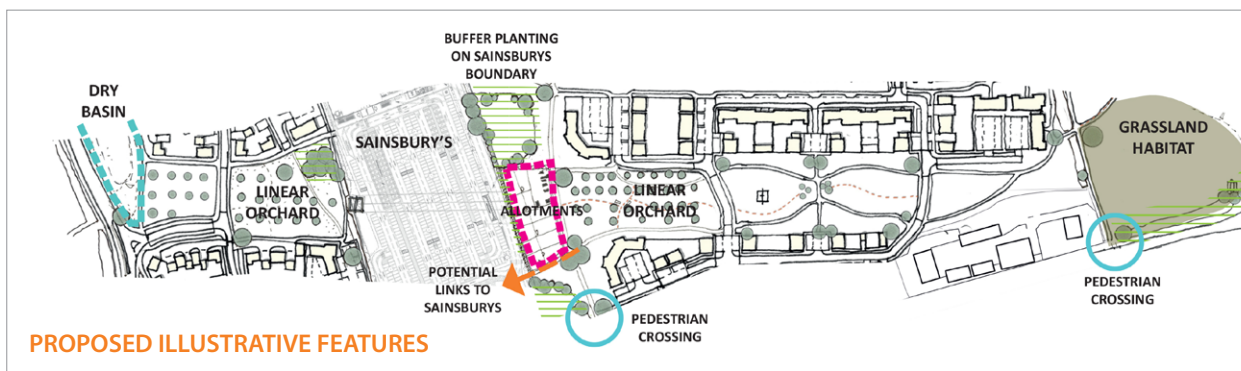
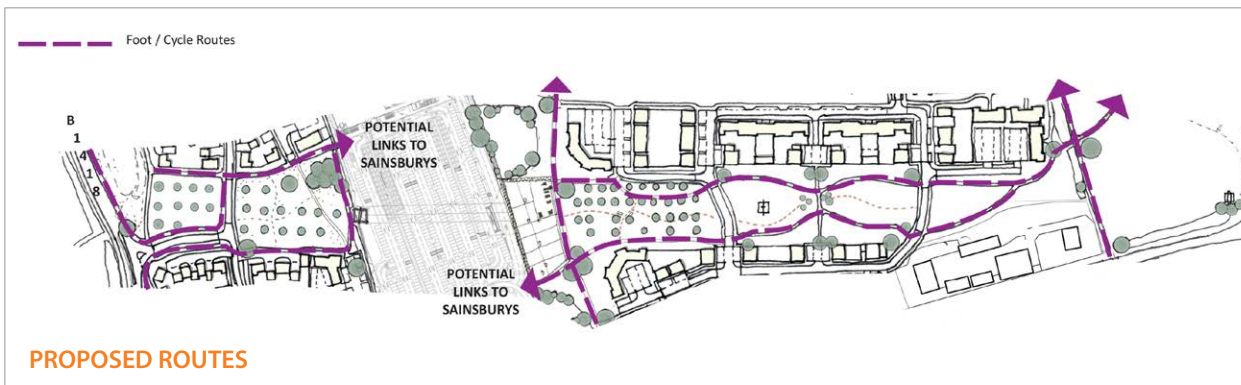
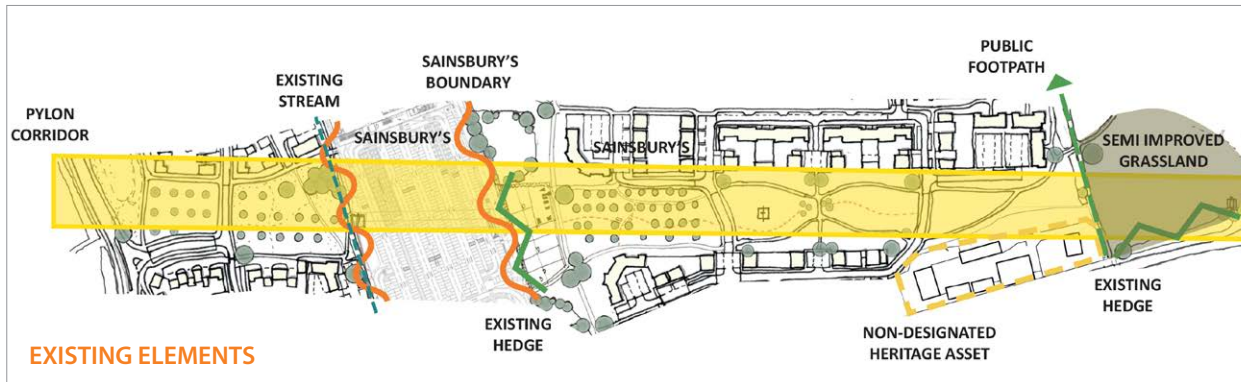

## L10 PYLON CORRIDOR

- Scale** 60m x 880m
- Function** Linear corridor through the site with walking and cycling routes connecting the development
- Landscape features** Linear Orchard  
Enhanced grassland
- Benefits** Allotments  
Biodiversity enhancements  
Connections to the PRoW network

